

CONQUEST[®] Dimensional Data and Weights

Laterals - PTFE Only

Fitting Dia.	Option	Part Number	A	B	C	D
2"	Flange on Outlet	LN00M3WWZR200	6 5/8	4 13/16	8 3/16	1'-1"
2"	Flange on Run	LN00M3WZWR200	8 3/16	4 13/16	8 1/8	1'-015/16
3"	Flange on Run	LN00M3WZWR300	11 3/8	6 13/16	1'-1 9/16	1'-8 3/8

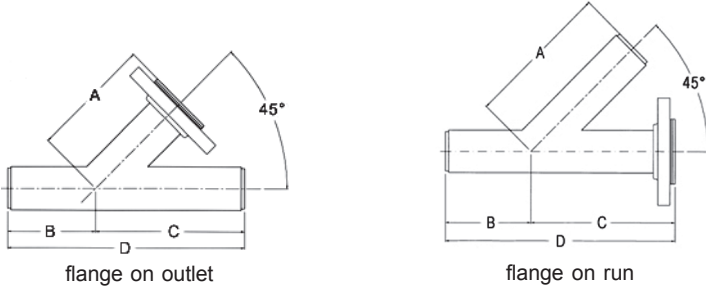

90° Elbows

Fitting Dia. in. (mm)	A in. (mm)	PTFE	PVDF	PP	Weight lbs. (kg)
1 (25)	11 (279)	E900M3WW00100	E900K3WW00100	E900P3WW00100	4 (1.8)
1.5 (40)	13 (330)	E900M3WW00B00	E900K3WW00B00	E900P3WW00B00	7 (3.2)
2 (50)	15 (381)	E900M3WW00200	E900K3WW00200	E900P3WW00200	10.4 (4.7)
3 (80)	21 (533)	E900M3WW00300	E900K3WW00300	E900P3WW00300	28.5 (13.2)
4 (100)	26 (660)	E900M3WW00400	E900K3WW00400	E900P3WW00400	50.1 (22.7)

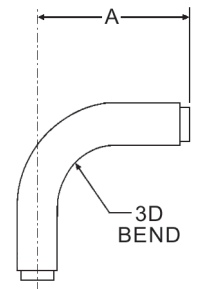

45° Elbows

Fitting Dia. in. (mm)	B in. (mm)	PTFE	PVDF	PP	Weight lbs. (kg)
1 (25)	8 (203)	E500M3WW00100	E500K3WW00100	E500P3WW00100	3 (1.4)
1.5 (40)	9 (229)	E500M3WW00B00	E500K3WW00B00	E500P3WW00B00	5 (2.3)
2 (50)	10 (254)	E500M3WW00200	E500K3WW00200	E500P3WW00200	7.5 (3.4)
3 (80)	13 (330)	E500M3WW00300	E500K3WW00300	E500P3WW00300	19.1 (8.7)
4 (100)	17 (432)	E500M3WW00400	E500K3WW00400	E500P3WW00400	36 (16.3)

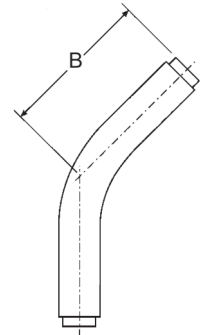

Adapters

Dia. in. (mm)	E in. (mm)	F in. (mm)
1 (25)	10 (254)	4 (102)
1.5 (40)	11 (279)	5 (127)
2 (50)	12 (305)	6 (152)
3 (80)	15 1/2 (394)	8 (203)
4 (100)	18 (457)	8 (203)

Adapter With Flange

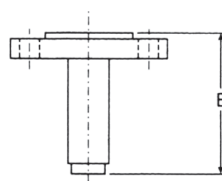

Adapter Without Flange

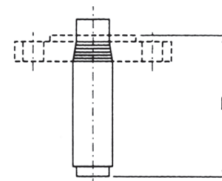

CONQUEST® Dimensional Data and Weights

Standard Tees and Instrument Tees

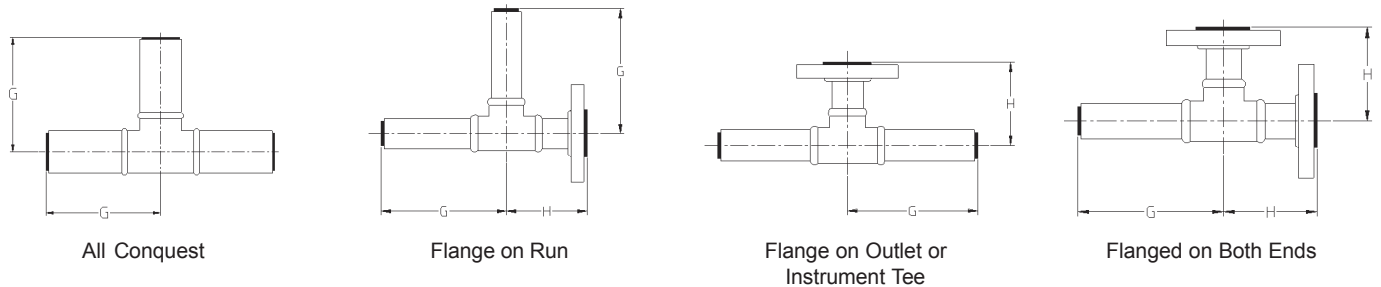

Size (NPS)	Dimensions (in.)		Option	PTFE	PVDF	PP
	G	H				
1	5 1/2	3 1/2	All CONQUEST®	TN00M3WWW0100	TN00K3WWW0100	TN00P3WWW0100
			Flange on Run	N/A	TN00K3WZWS100	TN00P3WZWS100
			Flange on Outlet	N/A	TN00K3WWZS100	TN00P3WWZS100
			Flange on Both	N/A	TN00K3WZZS100	TN00P3WZZS100
			Instrument	T400M3WWZS110	T400K3WWZS110	T400P3WWZS110
1.5	6	4	All CONQUEST®	TN00M3WWW0B00	TN00K3WWW0B00	TN00P3WWW0B00
			Flange on Run	N/A	TN00K3WZWSB00	TN00P3WZWSB00
			Flange on Outlet	TN00M3WWZNB00	TN00K3WWZSB00	TN00P3WWZSB00
			Flange on Both	N/A	TN00K3WZZSB00	TN00P3WZZSB00
			Instrument	T400M3WWZSB10	T400K3WWZSB10	T400P3WWZSB10
2	6 1/2	4 1/2	All CONQUEST®	TN00M3WWW0200	TN00K3WWW0200	TN00P3WWW0200
			Flange on Run	N/A	TN00K3WZWS200	TN00P3WZWS200
			Flange on Outlet	TN00M3WWZNB200	TN00K3WWZS200	TN00P3WWZS200
			Flange on Both	N/A	TN00K3WZZS200	TN00P3WZZS200
			Instrument	T400M3WWZS210	T400K3WWZS210	T400P3WWZS210
3	7 1/2	5 1/2	All CONQUEST®	TN00M3WWW0300	TN00K3WWW0300	TN00P3WWW0300
			Flange on Run	N/A	TN00K3WZWS300	TN00P3WZWS300
			Flange on Outlet	N/A	TN00K3WWZS300	TN00P3WWZS300
			Flange on Both	N/A	TN00K3WZZS300	TN00P3WZZS300
			Instrument	T400M3WWZS310	T400K3WWZS310	T400P3WWZS310
4	9 1/2	6 1/2	All CONQUEST®	TN00M3WWW0400	TN00K3WWW0400	TN00P3WWW0400
			Flange on Run	N/A	TN00K3WZWS400	TN00P3WZWS400
			Flange on Outlet	N/A	TN00K3WWZS400	TN00P3WWZS400
			Flange on Both	N/A	TN00K3WZZS400	TN00P3WZZS400
				T400M3WWZS410	T400K3WWZS410	T400P3WWZS410

Instrument port outlet is 1" pipe size

CONQUEST® Dimensional Data and Weights

Concentric Reducers

Fitting Dia. in. (mm)	D in. (mm)	PTFE	PVDF	PP	Weight lbs. (kg)
1.5 x 1 (40 x 25)	6.5 (165)	6000M3WW00B10	6000K3WW00B10	6000P3WW00B10	7 (3.2)
2 x 1 (50 x 25)	7.5 (191)	6000M3WW00210	6000K3WW00210	6000P3WW00210	7 (3.2)
2 x 1 1/2 (50 x 40)	7.5 (191)	6000M3WW002B0	6000K3WW002B0	6000P3WW002B0	7 (3.2)
3 x 2 (80 x 50)	10.5 (267)	6000M3WW00320	6000K3WW00320	6000P3WW00320	14 (6.4)
4 x 3 (100 x 80)	13 (330)	6000M3WW00430	6000K3WW00430	6000P3WW00430	30 (13.6)

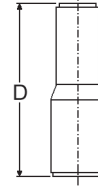

Standard Tee-to-Concentric Reducer

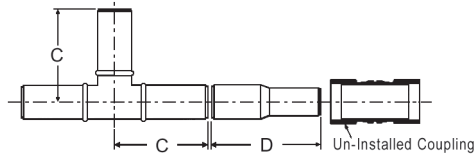

Tee-to-decreasing size concentric reducer, no filler pipe needed.

Standard Tee-to-Tee, or Tee-to-Concentric Reducer

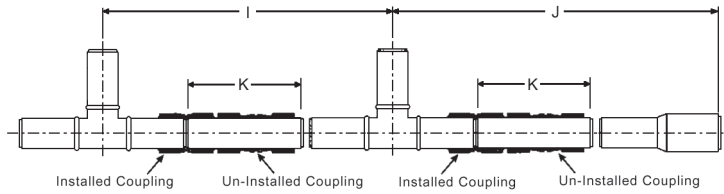

Minimum tee-to-tee or tee-to-increasing size concentric reducer length.

Fitting Dia. in. (mm)	I in. (mm)	J in. (mm)	K in. (mm)
1 (25)	20 (508)	21 (533)	9 3/8 (238)
1.5 (40)	23 3/4 (603)	23 3/4 (603)	10 5/8 (270)
2 (50)	24 5/8 (625)	28 5/8 (727)	12 (305)
3 (80)	30 1/2 (775)	31 1/2 (800)	15 7/8 (403)
4 (100)	37 1/4 (946)	40 3/4 (1035)	18 1/4 (464)

CONQUEST® Coupler Dimensions

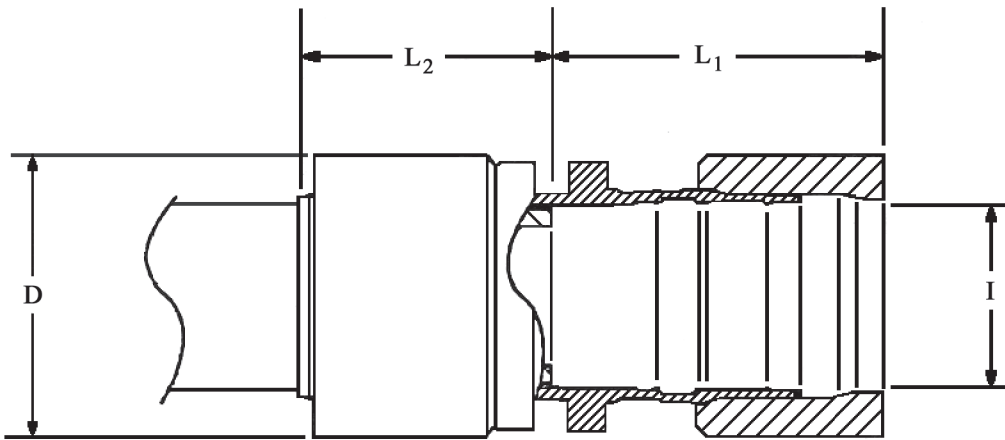

Fitting Size in. (mm)	(2xL ₁) Overall Length Max. Prior to Installation	(2xL ₂) Overall Length, Max. After Installation	D Outside Diameter, Max.	I Inside Diameter, Max.
1 (25)	4.55	3.42	1.97	1.338
1 1/2 (40)	5.44	4.10	2.64	1.923
2 (50)	6.54	5.03	3.28	2.415
3 (80)	9.55	6.80	4.45	3.536
4 (100)	11.03	7.77	5.60	4.551

1. Fittings are designed for use on Resistoflex plastic-lined steel pipe, schedule 40.
2. Standard coating for Swage Rings is black oxide per LMS-93-12. Contact factory for other platings.
3. Fittings available with and without 1/8" vent hole between tool flange.